

AQUAPRO

CREATE A BIT OF BRILLIANCE IN YOUR OWN BACKYARD

AP5000UV PRESSURE FILTER UV CLARIFIER - INSTRUCTIONS -



MODEL
AP5000UV

HOTLINE 1300 278 283 PHONE +61 (8) 6260 1000

EMAIL SALES@AQUAPROONLINE.COM.AU

DATE
NOV 2023 v3.0

WWW.AQUAPROONLINE.COM.AU



AQUAPRO

CONGRATULATIONS ON YOUR PURCHASE OF THIS PRODUCT BY AQUAPRO.

TECHNICAL SPECIFICATIONS

DESCRIPTION	AP5000UV
MAXIMUM WATER FLOW	3000L/H
POWER CONSUMPTION	15W
VOLTS	240V
CABLE LENGTH	5M
MAX. POND SIZE OVER 75CM AVERAGE DEPTH & SHADED	5000L
MAX. POND SIZE WITH FISH, FULL SUNLIGHT & SHALLOW	1500L
FILTER VOLUME	20L
UVC SIZE	11W
RECOMMENDED TUBING SIZE (MM) ID	25 / 32 / 40MMØ
RECOMMENDED PUMP	AP3100DW

Please read these instructions and familiarise yourself with the equipment before placing it in service. Correct and safe use of the system requires strict compliance with the safety instructions. For safety reasons persons less than 16 years of age or people that are not familiar with these instructions should not use this equipment.

BENEFITS

YOUR AQUAPRO POND FILTER HAS BEEN MANUFACTURED WITH ADVANCED TECHNOLOGY TO PROVIDE YOU WITH THE BEST QUALITY FILTER FOR YOUR POND WATER.

- The easy-clean backwash function, back flushes the filter, and compresses the foam sponge media aiding easy cleaning. The back-flush function completely reverses the flow, to aid with removing sludge build-up in the bottom of the filter.
- In normal operation the water enters the filter and is forced around the perimeter creating a vortex where larger particles are precipitated through gravity and the smaller particles get caught as they flow through the sponge filters horizontally.
- The yellow and blue filter sponges differ in density. The higher density foam allows the water to pass through at a slower flow rate promoting colonization of Nitrosomonas bacteria and the lower density sponge allows the water to pass through faster promoting colonization of Nitrobacta bacteria. The large surface area of the Bio-spheres aid biological filtration and ensures maximum biological purifying action. The water is then cleaned by the Ultraviolet ray which inhibits algae growth and the clean water exits the filter back into the pond

AP5000UV PRESSURE FILTER

INSTRUCTIONS

PRODUCT SPECIFIC SAFEGUARDS

- Do not operate the UVC Lamp without water at any time, permanent damage may occur.
- The pump is designed to be used in a Fresh water Garden pond. It is not to be used in any other manner or purpose. The pump should only be used in clean water.
- AQUAPRO Filtration & Waterfall Pumps are cooled by water flowing through the inside of the motor body. If the pump flow becomes restricted it will overheat and could cause permanent damage. Large tubing size is strongly recommended to deliver adequate water flow to cool the pump. The pump needs to be cleaned regularly to prevent the pump becoming blocked, thus causing the pump to overheat and burn out. This is not a warrantable event. It is strongly recommended not to select a pump that is too small for the job required. The flow rate through the pump needs to be strong enough so that a half of the rated max flow is kept running at all times.

INSTALLATION

IDENTIFY A SUITABLE LOCATION FOR YOUR NEW PRESSURE FILTER.

- Do not submerge this product in water. The pressure filter should be used inline, between a pump and a water feature or waterfall. The filter can also be partially buried to help disguise it in your garden.
- Place the filter on a firm and level base, e.g. on a slab. Please make sure that there is unhindered access to the lid in order to be able to carry out maintenance on the filter, e.g. cleaning the filter sponges.
- It is good practise to design the plumbing beforehand. Ensure the pipes are laid out such that the clean filtered water return is to the opposite end of your pond to where the pump suction is located. This aids circulation and is to avoid stagnant spots.
- Select the hose tail, locking nut, and flat rubber washer. Assemble as per diagram. Insert into the end of tubing.
- Connect anti-kink hose or poly tubing from your pump outlet to the inlet of the filter.
- If your filter has a three step hose tail to suit smaller tubing, then be sure to cut off the hose tails that are smaller than the hose size you are using. For example, If using 40mm hose, cut off the 25 & 32mm sections. Please use the largest size tubing possible. We recommend using AQUAPRO hose clamps for a leak free connection.
- Connect the tubing from the outlet of the filter back into your pond at the opposite end to where you are pumping from. It's possible to have the outlet of the filter running into a waterfall. You only need to connect tubing to the back-flush outlet if you require the dirty water from the backwash to be diverted to a specific location.
- If the flow from your pump is greater than the recommended max flow, you must reduce the flow, or bypass some of the water with a Y junction piece between the pump and the filter. The flow of water through branch of the Y junction can be varied by use of an optional valve. The pressure must not exceed 3M head pressure.
- The filter must be operational 24 hours every day for it to function effectively.
- Turn your pump on and then plug in the UV-C unit on the filter. The UV-C unit should not be turned on if there is no water flowing post the UV-C unit.
- It is recommended to boost the biological function of your filter with AQUAPRO Bacteria. This will greatly increase the efficiency of the unit.
- Now sit back, relax and enjoy a clean and healthy pond.

AQUAPRO

CLEANING

BEGIN BY ENSURING THAT THE MAINS POWER SUPPLY IS DISCONNECTED BEFORE ATTEMPTING ANY MAINTENANCE OR ADJUSTMENT OF THE UNIT OR THE WATER BODY. REMOVE THE UNIT FROM THE WATER.

THE FILTERS AND SPONGES IN THIS UNIT WILL CLOG OVER TIME. PLEASE CLEAN REGULARLY (AT LEAST ONCE A MONTH) TO ENSURE STRONG WATER FLOW. FAILURE TO MAINTAIN THE UNIT WILL RESULT IN A BURNT OUT MOTOR AND OTHER DAMAGE.

- Disconnect power cord from the power supply before performing maintenance. Never lift the filter by the power cord.
- Check the UV-C globe regularly and replace every 11 months – 8,000 operating hours. Failure to replace the globe before the end of its life span may cause electrical damage. Also, the globe UV intensity diminishes over time. To visually check the globe, look through the clear UV-C indicator on the top of the filter and if the light is working you will see a faint purple glow. This may have to be done at night to see distinctly.

FEATURES

1. Hose Inlet from Pump
2. Perimeter direction of water flow creating vortex for particle precipitation
3. Sponge Bio-media for Mechanical Filtration
4. Biological Spheres
5. UVC Chamber
6. Hose Outlet for return back to pond
7. Waste Water Outlet
8. Cleaning Indicator
9. Handle for Back Flush Cleaning System



AP5000UV PRESSURE FILTER

INSTRUCTIONS

TROUBLESHOOTING

PROBLEM	REASON	SOLUTION
WATER NOT CLEARING UP	UNITS HAS NOT BEEN ALLOWED TO RUN LONG ENOUGH	FULL EFFECT OF THE BIOLOGICAL CYCLE HAS NOT BEEN ALLOWED TO MATURE. THIS CAN TAKE UP TO 8 WEEKS.
	INAPPROPRIATE PUMP SIZE	WATER FLOW IS TOO FAST FOR THE BIOLOGICAL CYCLE SETTLE MATURE, OR THE TOTAL WATER FLOW IS NOT ENOUGH FOR THE FOR THE POND VOLUME .
	THE POND AS A WHOLE IS EXTREMELY DIRTY	REMOVE DEBITS FROM THE POND, FOR EXAMPLE STRINGY ALGAE, LEAVES, LONG STANDING SLUDGE BUILD-UP FROM THE BOTTOM OF THE POND
	FISH STOCKS ARE TOO HIGH FOR SYSTEM	INCREASE FILTER AND PUMP SIZE
	FILTER SPONGES ARE DIRTY	INCREASE THE FREQUENCY OF FILTERS BACK FLUSH AND EASY CLEANING FUNCTION TILL WATER BECOMES CLEARER OVER TIME. SOME EXTREME SITUATIONS MAY REQUIRE WEEKLY BACK FLUSHES
	UV QUARTZ SLEEVE IS DIRTY	REMOVE AND CLEAN AS PER CLEANING INSTRUCTIONS
UV LAMP INDICATOR IS NOT LIT	THE FAINT BLUE GLOW FROM THE UV GLOBE MAY NOT BE VISIBLE DURING BRIGHT SUNLIGHT HOURS	WAIT TILL EVENING TO CHECK THE ILLUMINATION.
	CHECK THAT THE UV UNIT HAS POWER AND THE POWER POINT IS TURNED ON	TURN ON POWER
	THE UV GLOBE MAY BE DEFECTIVE	REPLACE THE UV BULB.
NO WATER DISCHARGE OUT OF THE FILTER OUTLET	BACK FLUSH KNOB IS POINTING TOWARDS THE BACK FLUSH OUTLET	TURN KNOB TOWARDS THE OUTLET DIRECTION
	THE PUMP MAY NOT BE CONNECTED TO POWER	TURN ON POWER
	POND PLUMBING IS BLOCKED	FIND BLOCKAGE & REMOVE
NO WATER DISCHARGE OUT OF THE WASTE WATER OUTLET	THE INLET AND OUTLET HOSES MAY BE ON THE WRONG WAY ROUND	SWITCH THE POSITIONS FOR HOSES, SUCH THAT THE INLET IS CONNECTED TO THE CORRECT PORT
	THE BACK FLUSH KNOB HAS JUMPED THE COGS IN THE LID UNIT	OPEN UP THE FILTER LID AND RE-ALIEEN THE COGS SO THAT THE TEETH MATCH UP CORRECTLY

AQUAPRO

PARTS

PART NO.	DESCRIPTION	AP5000UV
1	ELECTRICAL BALLAST & LAMP HOLDER ASSEMBLY COMPLETE	11MC929
2 & 3	BALLAST 72MM x 2.65MM O'RING AND PLASTIC O'RING HOLDER SET	11MC926
4	TWO PIN UV GLOBE - 240V - 11W - AQUAPRO	11AU179
	TWO PIN UV GLOBE - 240V - 11W - OSRAM - LONG LIFE	11PS265
5	48MM x 3.1MM O'RING (CLEAR SILICONE X2) OR (TWIN-RED X1)	11MC928
6	QUARTZ GLASS SLEEVE - 11W - Ø44.5 x 1.5 x 205MM	11MC927
7	QUARTZ SLEEVE LOCKING NUT	13PF010
8	FILTER LID	AVAILABLE ON REQUEST
9	SPONGE SET - 2 YELLOW & 2 BLUE - FINE - (WITHOUT SPOOL) Ø260 x 50	13PF051
10	BASE PLATE	AVAILABLE ON REQUEST
11	BASE ANCHOR SCREW - CLEAR	13PF006
12	LID CLAMP - PLASTIC - Ø375MM	11MC925
13	LID O'RING 346MM x 8.0MM	11MC923
14	FILTER BASE BUCKET	AVAILABLE ON REQUEST
15	EASY CLEAN HANDLE	11MC930
16	SQUARE SHAFT CONNECTOR	AVAILABLE ON REQUEST
17	SHAFT AND LID BEARING BUSH	AVAILABLE ON REQUEST
18	INLET AND OUTLET GASKET WASHER X 3	KIT CODE 11MC924 *
19	STEPPED HOSE TAIL X2	
20	INLET/OUTLET LOCKING NUT X2	
21	ROTATING CLEANING FLAPPER	AVAILABLE ON REQUEST
22	LOWER BUSH BEARING	AVAILABLE ON REQUEST
23	STAINLESS STEEL WASHER	AVAILABLE ON REQUEST
24	STAINLESS STEEL MACHINE SCREW	AVAILABLE ON REQUEST

NOT SHOWN - Back Flush Outlet Valve - *Kit Code 11MC924

SERVICE KITS

2, 4, 5, 9(2x Y, 2x B), 13, 18.(x3), 19.(x3), 20.(x3)	SERVICE KIT FOR PRESSURE FILTER AP5000UV	13PF043
---	--	---------

AP5000UV PRESSURE FILTER

INSTRUCTIONS

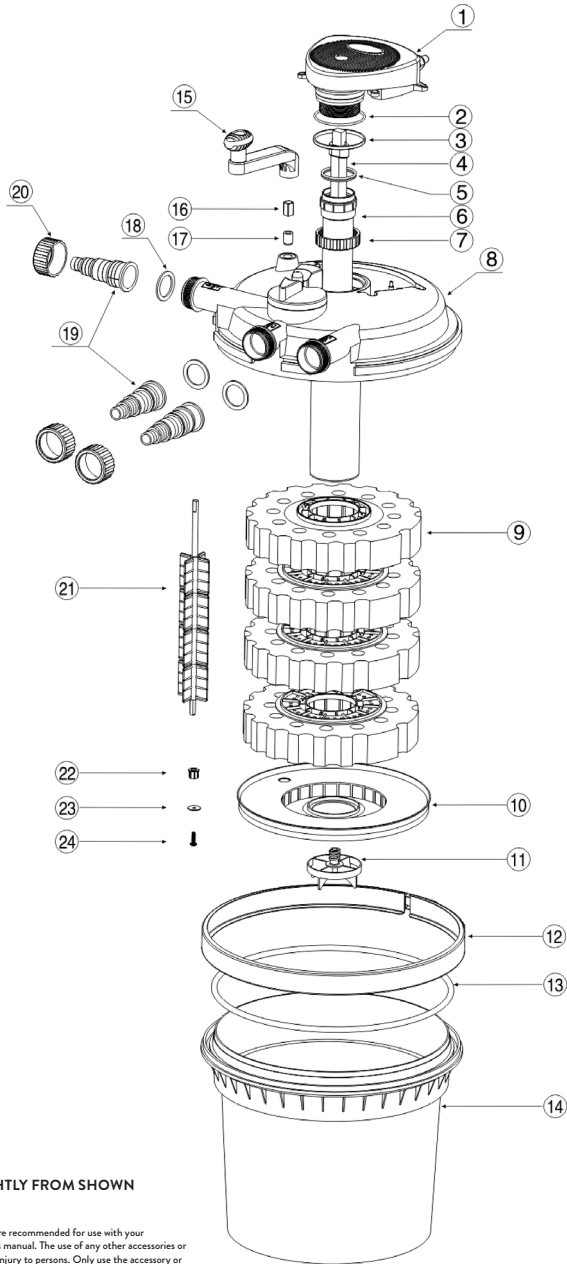

NOTE: PARTS MAY DIFFER SLIGHTLY FROM SHOWN



IMPORTANT

These accessories and attachments are recommended for use with your AQUAPRO product specified in this manual. The use of any other accessories or attachments might present a risk of injury to persons. Only use the accessory or attachment for its stated purpose.

IMPORTANT SAFEGUARDS

IMPORTANT: IF USED IN MARINE OR SALTWATER, DUE TO THE HARSH CONDITIONS THE WARRANTY IS VOID.

- Do not submerge this filter in water.
- Do not operate the filter without water at any time, permanent damage may occur.
- Do not look at an unshielded UV-C globe. Ultra Violet light is harmful to your eyes and may cause blindness.
- Do not over pressurise. Max head pressure is 3m.
- The filter is designed to be used in pond environment. It is not to be used in any other manner or purpose. The filter should only be used with water. Do not use the filter with any harsh chemicals such as a solvent or petrol.
- All pumps and filters are water cooled. If the flow becomes restricted it could cause permanent damage. The filter needs to be cleaned regularly to prevent the filter becoming blocked, thus causing damage. This is not a warrantable event. For your own safety, disconnect from the power supply before any maintenance of any equipment is attempted on the tank or water body.
- Do not operate the filter if any components of the system, such as the power cable, have been damaged.
- If required, have a qualified electrician install a weather proof power point near to the pond or water feature (within the cable length of the filter).
- Always use a properly grounded power supply that is connected to an RCD with a rated residual operating current not exceeding 30mA. As per AS/NZS 3350.2.41:1997
- The drip loop method should be used to prevent water from traveling down the cable and onto the plug or power supply. If the plug does get wet, do not unplug the cable. Disconnect the circuit breaker that supplies power to the power supply point. Then unplug and examine the plug and power supply point for presence of water. If the power point has become wet, you should consult an electrician before using the power point again.
- Always unplug the pump from the power supply when not in use or before performing any maintenance on the pump or on the aquarium. Never pull the power cord to disconnect the plug from the power supply. Grasp the plug and pull to disconnect. Care should be taken to arrange the power cable so that it cannot be accidentally tripped over or pulled.
- Do not install or store the appliance where it will be exposed to extreme hot or cold temperatures. Do not use with water above 35 ° C.
- Do not cut the cable as this will result in voiding your warranty. The power cord cannot be replaced. If the cord is damaged, the filter must be discarded.
- Do not attempt to repair the electrical appliance yourself. Return to an authorized service centre or place of purchase if a fault occurs, (regular maintenance is not considered repair and is required by user).

FOR MORE INFORMATION AND THE COMPLETE AQUAPRO RANGE VISIT WWW.AQUAPROONLINE.COM.AU

WARRANTY

WARRANTY COVERS ONLY APPLIANCE DEFECTS, FAULTY MATERIAL AND WORKMANSHIP WITHIN A 2 YEAR PERIOD.

- This product comes with a warranty against defects and motor failure (Warranty). The benefits provided in this Warranty are in addition to other rights and remedies available to you under the Australian Consumer Law. The Warranty is provided to the original purchaser of the product on the following terms:
- The Warranty is given by Aquatec Equipment Pty Ltd trading as Aquatec Equipment: 37 Edison Cct, Forrestdale, WA 6112. Tel 1300 552 202 or email sales@aquatecequipment.com.
- To make a claim under the Warranty you must return the faulty product to the place of purchase with a valid receipt or proof of purchase.
- A Warranty claim must be made within 2 year of the date of purchase.
- If your claim complies with the above terms and the product is not an Exhaustible Item and no Voiding Events have occurred, we will (at our sole discretion):
 - repair the product, if possible; or
 - provide a replacement product; or
 - if a replacement product is not available, provide a refund for the purchase price paid.
- You will bear the cost associated with claiming under the Warranty such as the cost of transportation and delivery of the product to and from the place of purchase.
- The product contains a complete Impeller Set, O Ring, UV Globe & Sponge Filters. These items are exhaustible (wear & tear) and are not covered under the Warranty.
- The Warranty will be void if any of the following events occur, as determined by us, at our sole discretion (Voiding Events):
 - any tampering/removal of warranty/identification labels or electrical components is evident;
 - the defect has arisen due to: an accident, incorrect or inadequate installation, misuse or abuse of the product (including improper maintenance and service), excessive wear and tear, not following manufacturer's guidelines/ instructions, or the product has been used in a manner contrary to the purpose or suitability of the product;
 - the product has been modified without our authority;
 - the defect is caused by power surges/spikes brownouts.
- Loss of livestock, damage to property or personal injury caused by the improper use or abuse of the product will not be covered and the manufacturer excludes all liability for such events, to the extent permitted by law.
- In addition to the Warranty set out above, our goods come with guarantees that cannot be excluded under the Australian Consumer Law. You are entitled to a replacement or refund for a major failure and for compensation for any other reasonably foreseeable loss or damage. You are also entitled to have the goods repaired or replaced if the goods fail to be of acceptable quality and the failure does not amount to a major failure.

HOTLINE 1300 278 283 PHONE +61 (8) 6260 1000

EMAIL SALES@AQUAPROONLINE.COM.AU

WWW.AQUAPROONLINE.COM.AU